

1 BHK



2 BHK



3 BHK



BUILDING
NO. 2



1 BHK



2 BHK



3 BHK



1ST FLOOR PLAN





2ND FLOOR PLAN





3RD TO 7TH, 9TH TO 12TH, 14TH TO 16TH FLOOR PLAN
(8TH & 13TH REFUGE FLOOR PLAN)

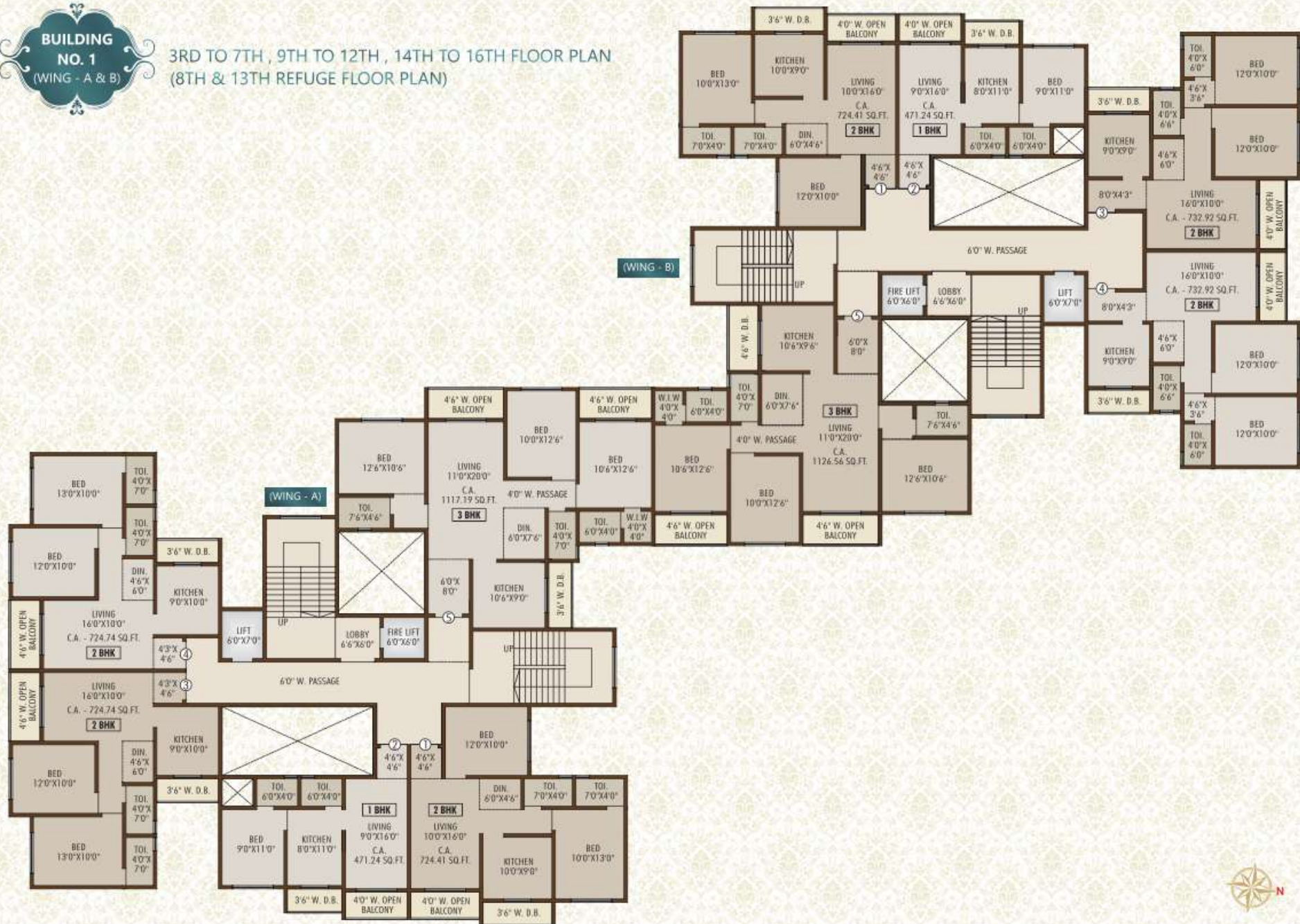



(WING - B)

(WING - A)



GROUND / STILT FLOOR PLAN



(WING - B)

(WING - A)



1ST FLOOR PLAN



BUILDING NO. 2
(WING - A & B)

2ND TO 7TH, 9TH TO 12TH, 14TH TO 16TH FLOOR PLAN



BUILDING NO. 2
(WING - A & B)

8TH & 13TH REFUGE FLOOR PLAN