



The Feeling... To Be a Part of.





The Feeling... To Be a Part of.

Typical Floor Plan

A B C Wing

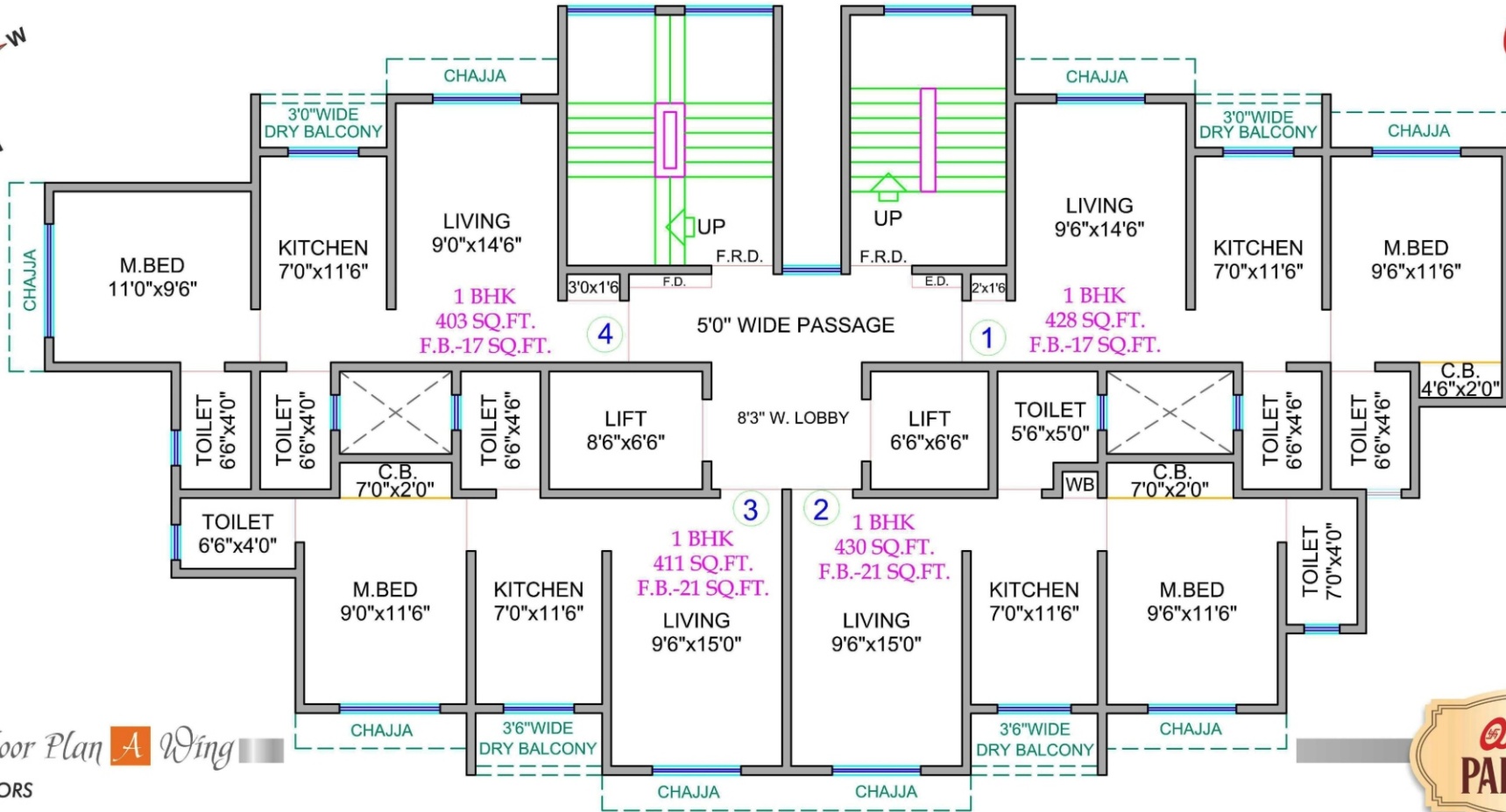

Typical Floor Plan **A** Wing

G+P+22 FLOORS



The Feeling... To Be a Part of.

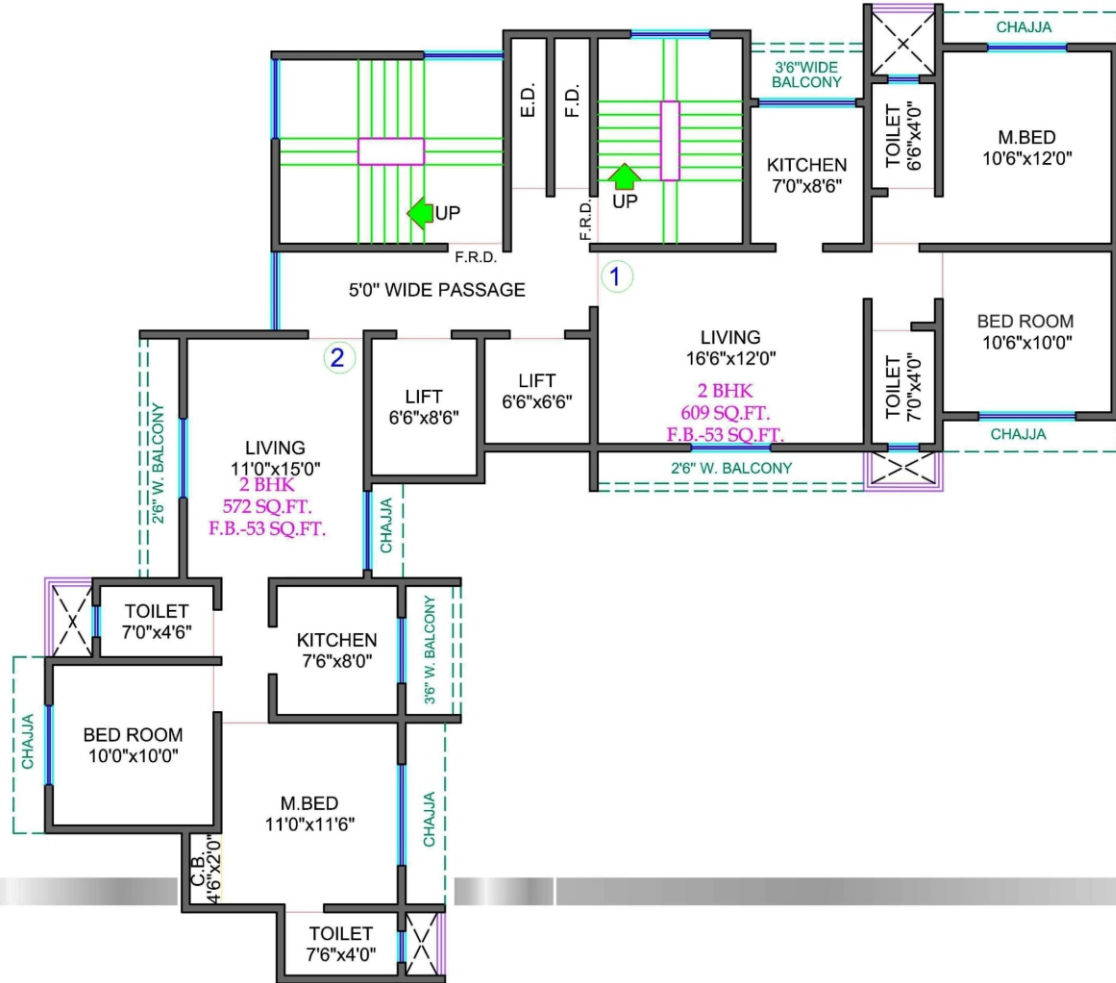

Typical Floor Plan **B** Wing

G+P+21 FLOORS



The Feeling... To Be a Part of.

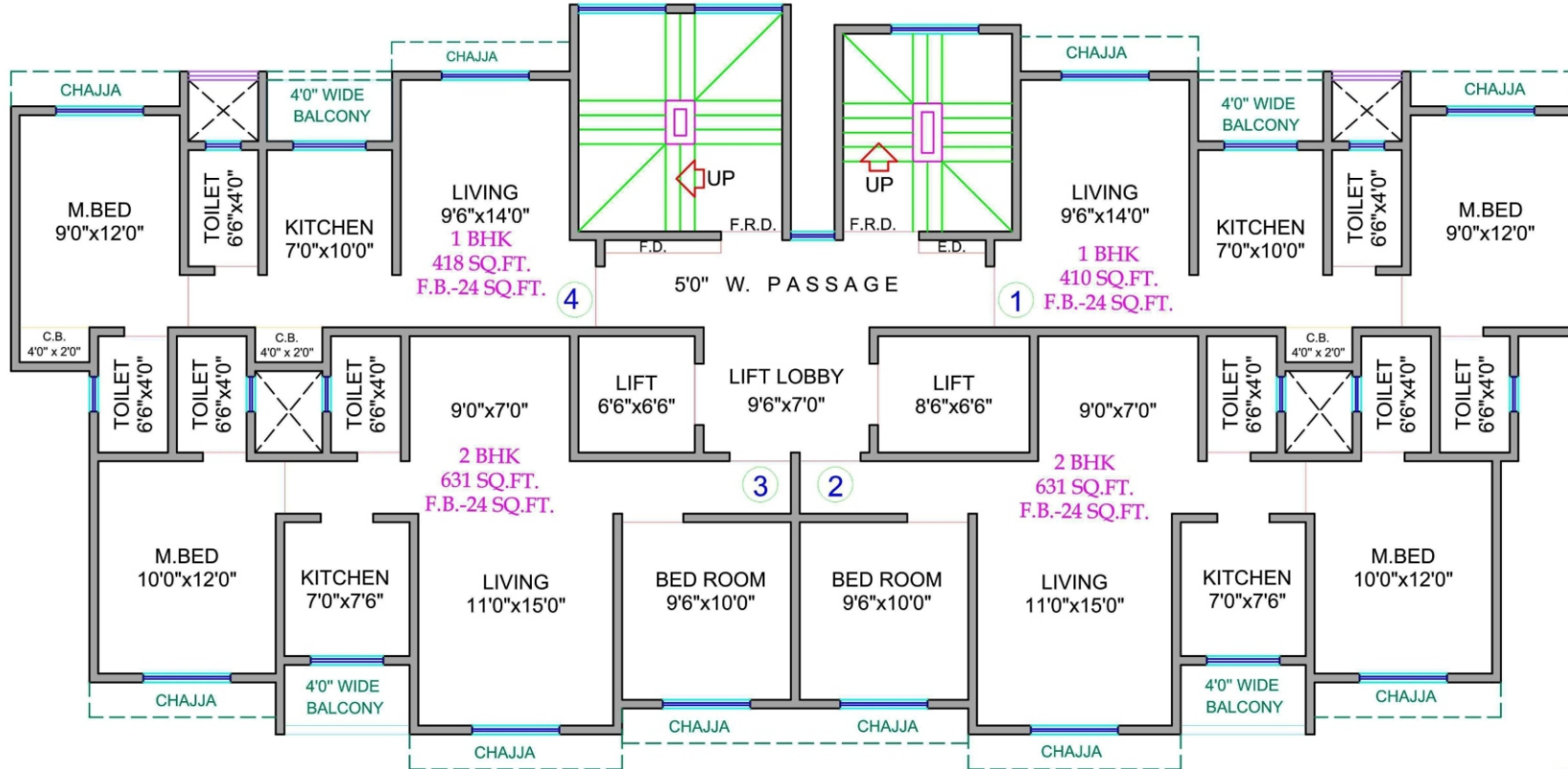
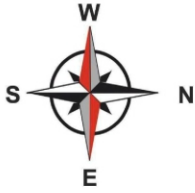



# Terrace View - Amenities

**B WING + C WING**

The Feeling... To Be a Part of.





**A** Wing 1 BHK



The Feeling... To Be a Part of.



Wing

1 BHK



The Feeling... To Be a Part of.









Introducing **Ostwal Paradise** a Beautifully Planned and Executed Offering from the Shree **Ostwal Builders Ltd.** Having Bold and striking Exteriors and Alluring Elevations, this Architectural marvel hosts Spacious and well designed 1BHK and 2BHK Homes with beautiful city Views.

Each and every minutest detail has been planned to ensure a feeling of Space and Comfort, these Homes are equipped with all Contemporary Amenities and Facilities to Provide a relatively Comfortable and Tranquil Lifestyle.

Ostwal Paradise is a Modern Residential High rise Tower which is Ergonomically Designed with Well Ventilated Flats and Elegant Interiors.

Each and Every Nook and Corner is Meticulously Designed into 1 BHK and 2BHK Apartments coupled with Sublime Comfort and Luxury in Appearance is what defines.

This Project in the heart of Mira Bhayander takes the **Joy of Living** to a New Level. Just a Stone's Throw away from Theater, Leading Banks, International Schools, Engineering Colleges, Luxurious Health Club and a Visual Delight in Culinary Experiences. All the Apartments are Carefully built, to enable you to experience the Bliss of an Epicurean Lifestyle in the Cozy Environs of Your Home.



The Feeling... To Be a Part of.



# Amenities

## IDEAL LOCATIONS

- Easy Connectivity to Western Express Highway
- Easy Connectivity to Metro Line
- Supermarkets at Walking Distance
- Mall and Multiplex within 5 minutes
- Hospitals within 5 minutes
- Easy Connectivity to Railway Stations

## EXTERNAL AMENITIES

- Attractive Entrance Lobby with Sitting Area
- Branded High Speed Elevators

## SAFETY AND SECURITY

- 24 Hours Security
- Back-up Generator for Emergency Power
- Fire Fighting Equipment
- CCTV Surveillance

## INTERNAL AMENITIES

- Attractive Main Door
- False Ceiling in the Living room
- Vitrified Tiles Flooring in Flat
- Semi Modular Kitchen
- Granite Platform and Stainless Steel Sink
- Full Tiles on Kitchen Wall
- Aqua Guard Point
- Exhaust Fan Point
- Dry Area for Washing Machine

## BATHROOM

- Anti-Skid floor Tiles
- Branded Sanitary Fittings
- Full Wall Tiles in Bathroom
- Loft on Bathroom
- Geyser provision
- Shower Fittings
- Wash Basin
- Mirror above Wash Basis



The Feeling... To Be a Part of.



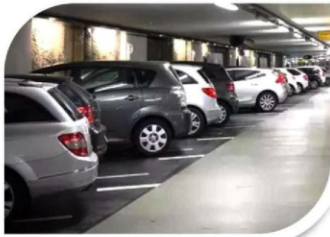

## Project Highlights

- Eye Catching Elevations
- Attractive Entrance Lobby
- Terrace Amenities
- Spacious Apartments
- Earthquake Resistant
- Rain Water Harvesting
- Modular Kitchens
- Surveillance Camera
- Hi Speed Elevators
- Children Play Area
- Terrace Garden
- Jogging Tracks
- Podium Parking
- 24hrs Security

*Some of our  
Projects*

श्री  
**Ostwal**  
**BUILDERS LTD.**



**OSTWAL PALACE**



**OSTWAL ORION**



**OSTWAL IMPERIAL**



**O. P. PLAZA**



**OSTWAL HORIZON**



**OSTWAL VILLAS**



*An address with Endless Possibilities*



**P51700048041**

Corporate Office :  
Ostwal House, Opp. Shivar Garden,  
Mira Bhayandar Road, Mira Road (E),  
Dist. Thane - 401 107

Site Address :  
Opp. Shivar Garden,  
Next to Ostwal House,  
Mira Bhayandar Road, Dist. Thane

Contact Details :  
Tel : 022-28557777 / 8082551600  
Email : info@ostwal.com  
Web : www.ostwal.com